



**22 Hazeldine Court, Longden Coleham, Shrewsbury, SY3 7BS**

1 bedroom first floor apartment—£195,000 Leasehold

## 22 Hazeldine Court, Longden Coleham, Shrewsbury, SY3 7BS

Coopergreenpooks.co.uk

£195,000 Leasehold—1 bedroom first floor apartment

Coopergreenpooks.co.uk/property/29435

Occupying a fantastic position with impressive views over the River Severn, this neatly presented retirement apartment offers practical and well-designed accommodation, while benefitting from beautifully landscaped communal gardens as well as a range of residents facilities. The property is conveniently located just a stone's throw from Coleham's excellent range of amenities and a short walk over the Greyfriar's bridge into the Quarry Park and town centre.

### KEY FEATURES

- Communal entrance with lift access to first floor
- Private inner hallway with useful storage
- Spacious living/dining room with glazed double doors opening to a Juliette balcony which looks directly over the communal gardens, River Severn and towards the English Bridge
- Fitted kitchen with integrated oven/hob and space for appliances
- Good sized double bedroom with built-in wardrobes
- Separate shower room with walk-in double length cubicle
- Residents and guests parking area
- Designed with the over 60's in mind, benefiting from 24 hr Careline alarm service, lift, communal lounge, laundry and full time house manager
- Regular social activities include coffee mornings, discussion groups, bridge, scrabble club, knit & natter and afternoon tea
- Sold with no upward chain

### FIRST FLOOR

APPROX. 50.2 SQ. METRES (540.6 SQ. FEET)

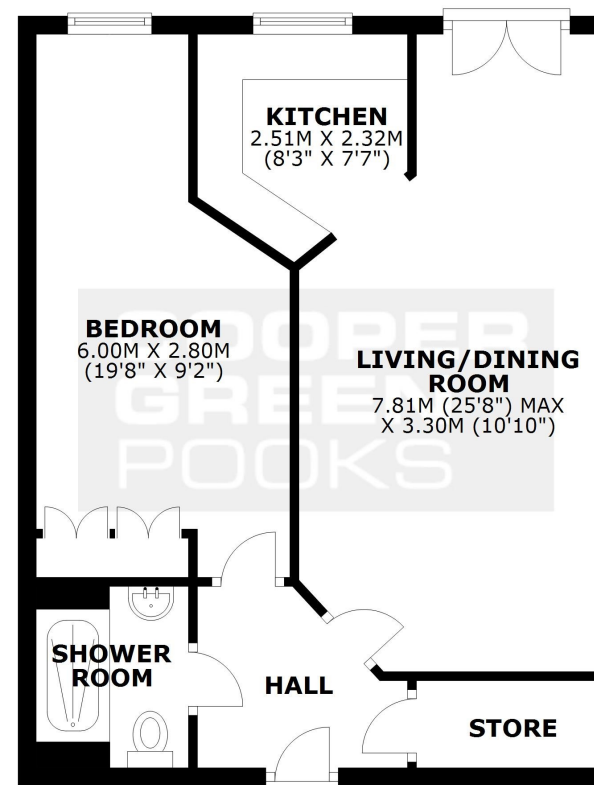

TOTAL AREA: APPROX. 50.2 SQ. METRES (540.6 SQ. FEET)

We accept no responsibility for any mistake or inaccuracy contained within the floorplan. The floorplan is provided as a guide only and should be taken as an illustration only. The measurements, contents and positioning are approximations only and provided as a guidance tool and not an exact replication of the property.  
Plan produced using PlanUp.







# 22 Hazeldine Court, Longden Coleham, Shrewsbury, SY3 7BS

£195,000 Leasehold—1 bedroom first floor apartment

Coopergreenpooks.co.uk/property/29435

rightmove

onTheMarket.com

RICS  
Regulated by RICS



Tenure	Leasehold
Local Authority	Shropshire Council
Council Tax	Band B
EPC Band	Band B
Ground Rent	£385 pa
Service Charge	£2222 pa
Lease	125 years from 2004
Services	Mains water, electricity and drainage are connected

**Expert mortgage advice available**  
3 Barker St, Shrewsbury SY1 1QF  
Cooper Green Pooks  
**01743 276666**



Your home may be repossessed if you do not keep up repayments on your mortgage.

There may be a fee for mortgage advice. The actual amount you pay will depend upon your circumstances. The fee is up to 1% but a typical fee is 0.3% of the amount borrowed.

## 22 Hazeldine Court, Longden Coleham, Shrewsbury, SY3 7BS

Coopergreenpooks.co.uk

£195,000 Leasehold—1 bedroom first floor apartment

Coopergreenpooks.co.uk/property/29435

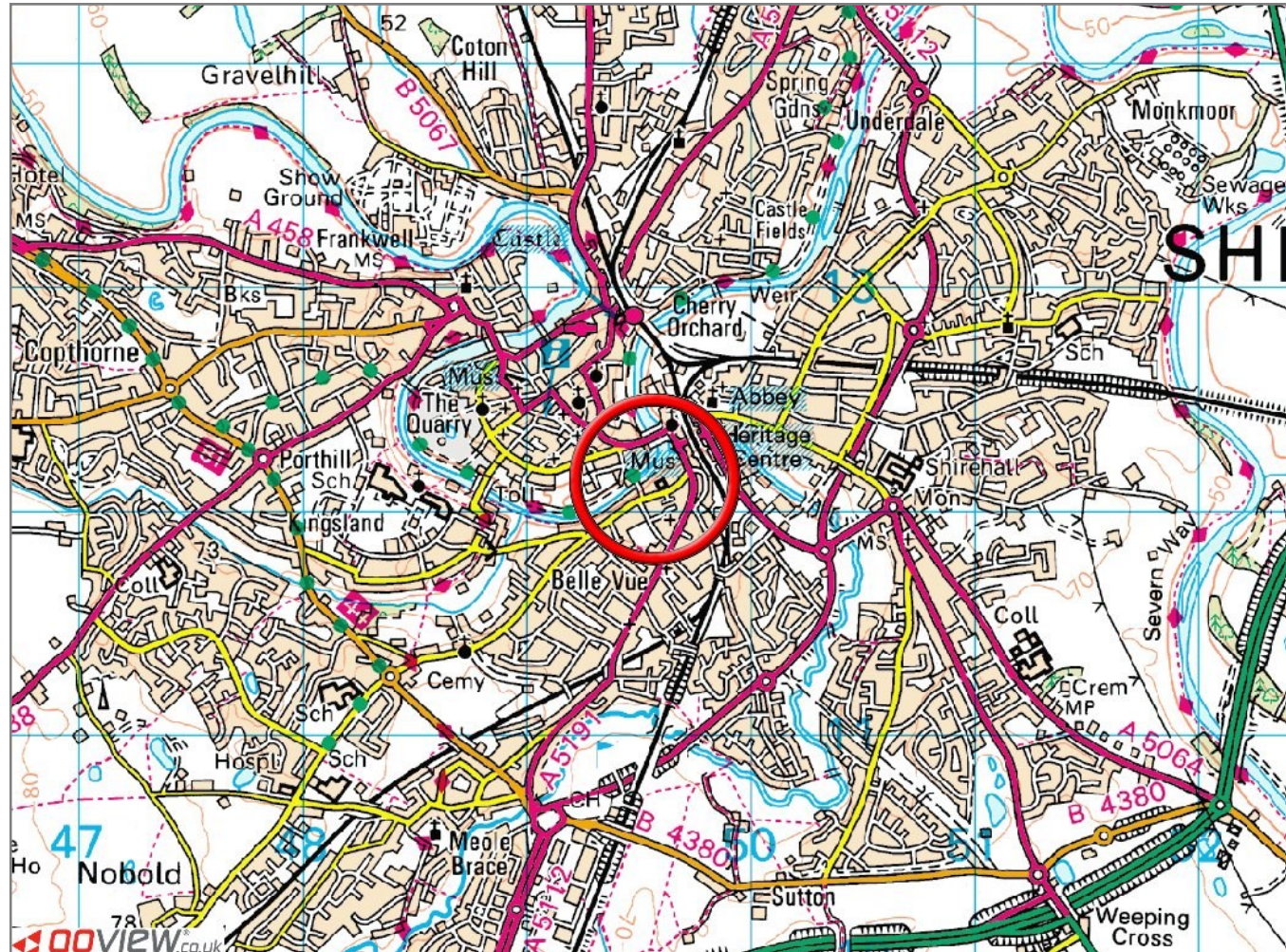

**IMPORTANT NOTICE:** Cooper Green Pooks for themselves and for the lessors or vendors of this property whose agents they are give notice that: 1 No appliances, services or service installations have been tested and no warranty as to suitability or serviceability is implied. Any prospective purchaser or lessee is advised to obtain verification from their surveyor or solicitor. 2. The particulars are set out as a general outline only for the guidance of the intended purchasers or lessees and do not constitute, nor constitute part of, an offer or contract. 3. All descriptions, reference to condition and necessary permissions for use and occupation and other details are given in good faith and are believed to be correct but any intending purchasers or lessees should not rely on them as statements or representation of fact but satisfy themselves by inspection or otherwise as to the correctness of each of them. 4. No person in the employment of Cooper Green Pooks has any authority to make or give any representation or warranty whatsoever in relation to this property. 5. All rentals and prices are quoted exclusive of Stamp Duty, legal and surveyors fees and any other associated purchasers or lessees costs. 6. Floor plans are indicative only and should not be relied on. 7. The plan showing the boundary of the property is indicative only and has not been checked against the legal title so should not be relied on. 8. All dimensions, floor areas and site areas are only approximate and should not be relied on. Dimensions are generally maximum room dimension.